

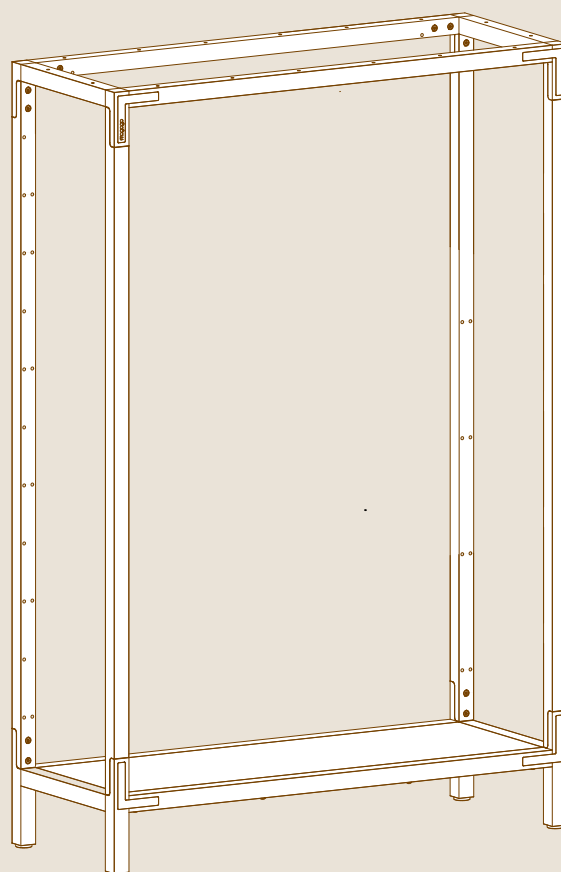

# EMPTY UNIT WITH LEGS

## ASSEMBLY INSTRUCTIONS



# PARTS

X16

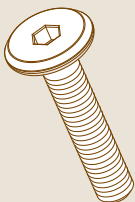

M6X30 FLAT HEAD SCREW

X1

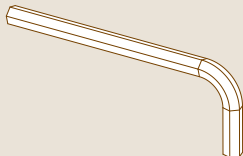

ALLEN KEY FOR  
M6 SCREWS

X1

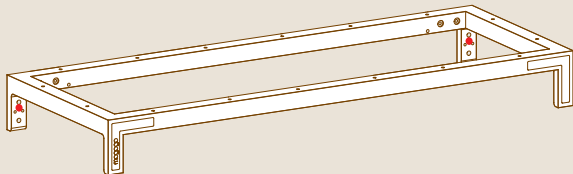

TOP FRAME

X4

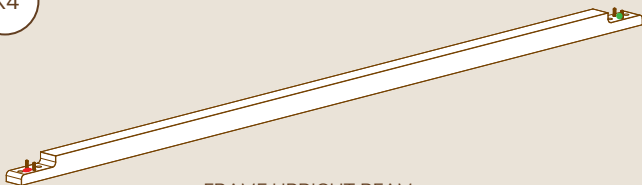

FRAME UPRIGHT BEAM

X1

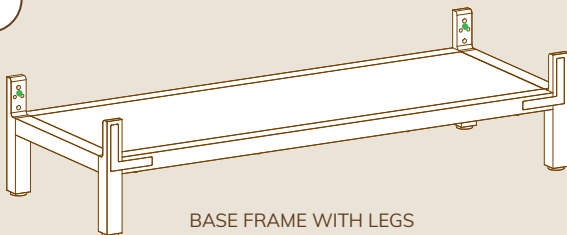

BASE FRAME WITH LEGS

# ASSEMBLY

1

Place Base and Top Frame apart from each other

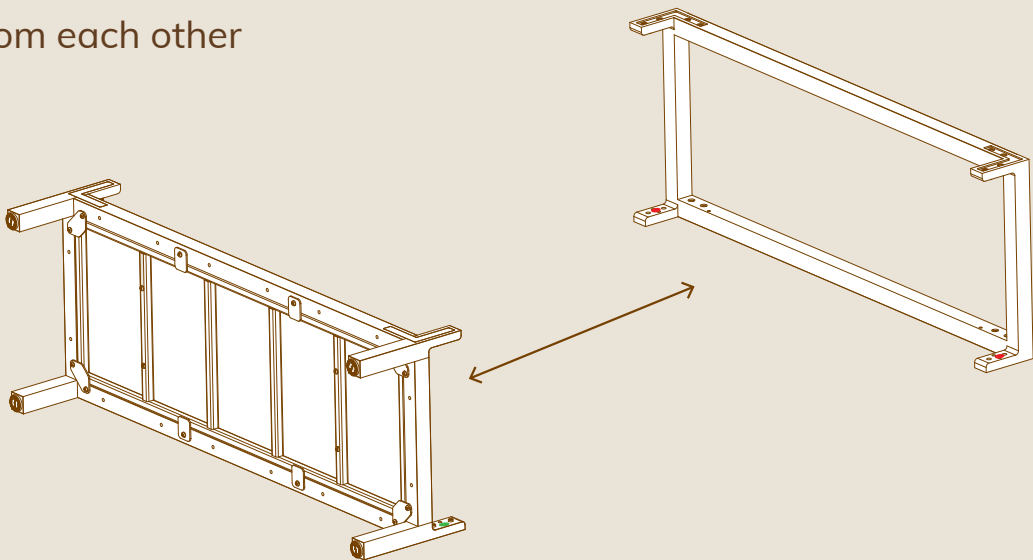

2

Assemble the frame uprights to the base frame.

Support the uprights while tightening!

**Make sure you connect each end of the beam to the right side**

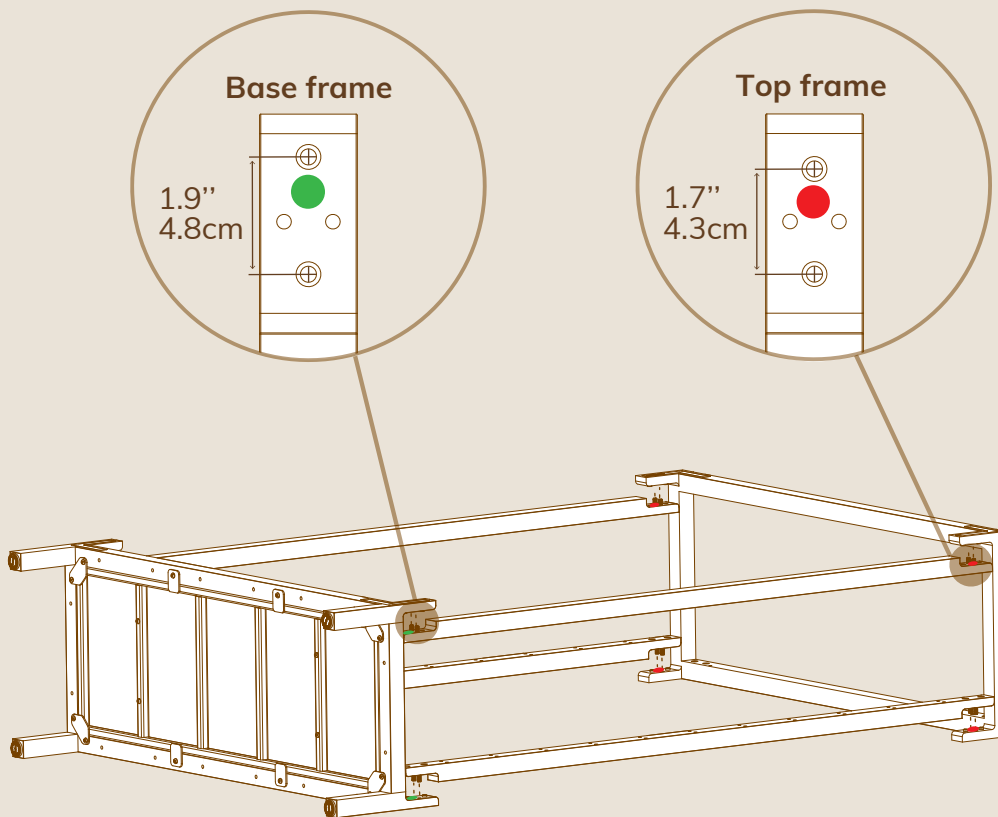

3

Tighten the frame uprights to the top frame

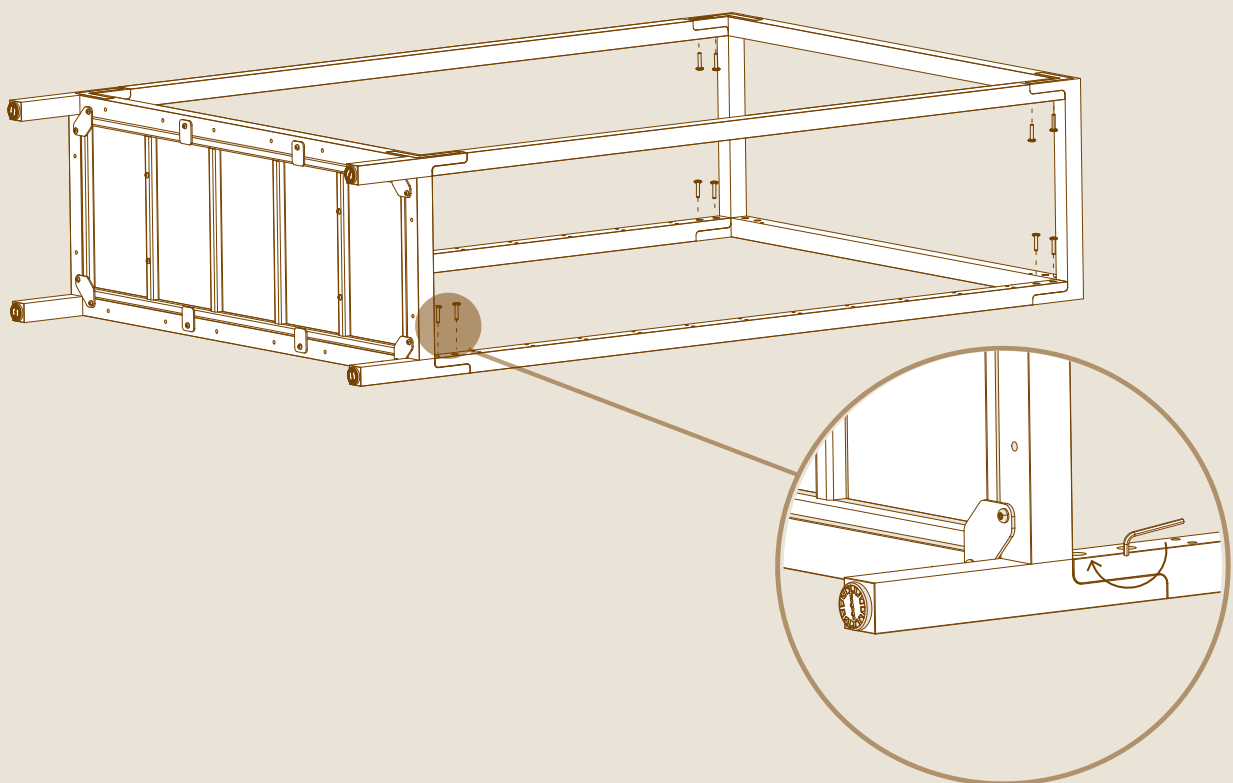

4

Set the Canvas unit upright.

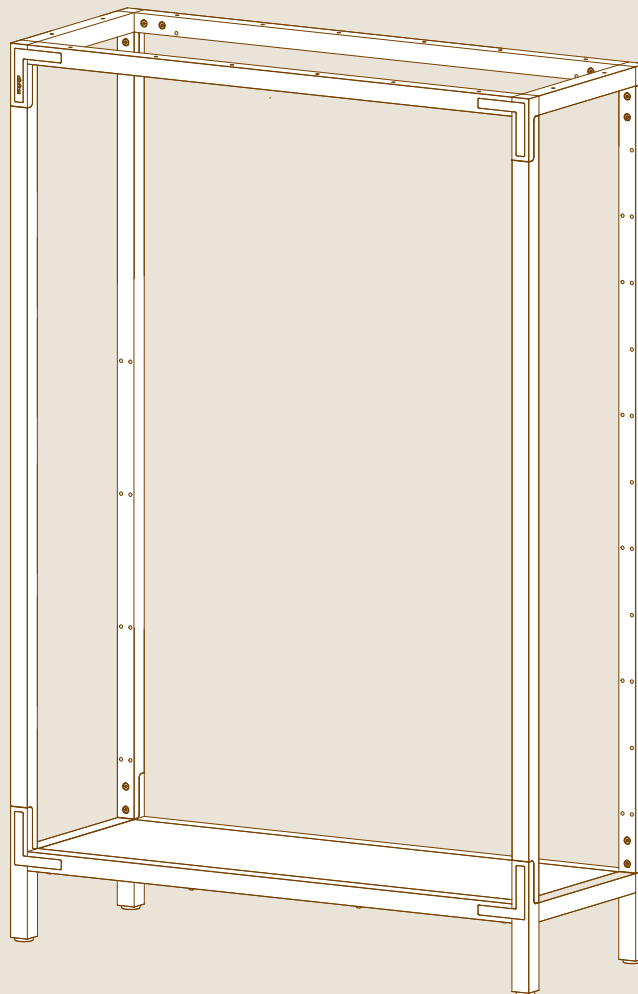

**GREAT JOB, YOUR GOOD TO GO!**